

# MAX SUPER ARM 2300

## PULL OPEN CURVED BRACKET

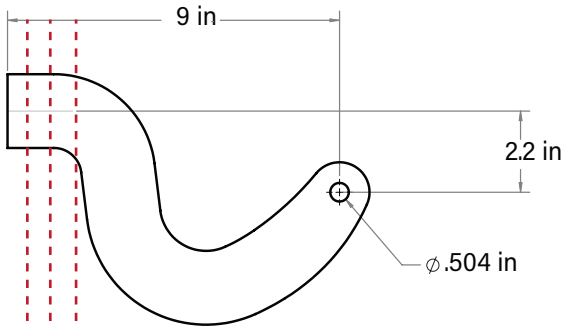

Mounting Hardware

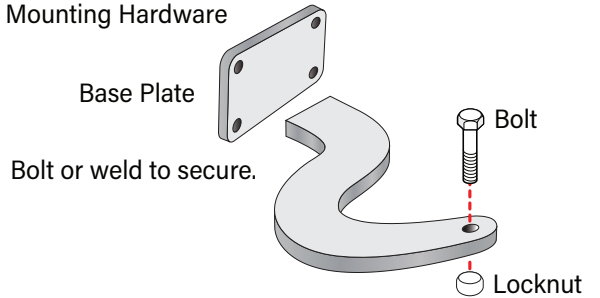

**Cut the base of the bracket to accomplish the proper B dimension.**

### 2300 PULL OPEN DIMENSIONS

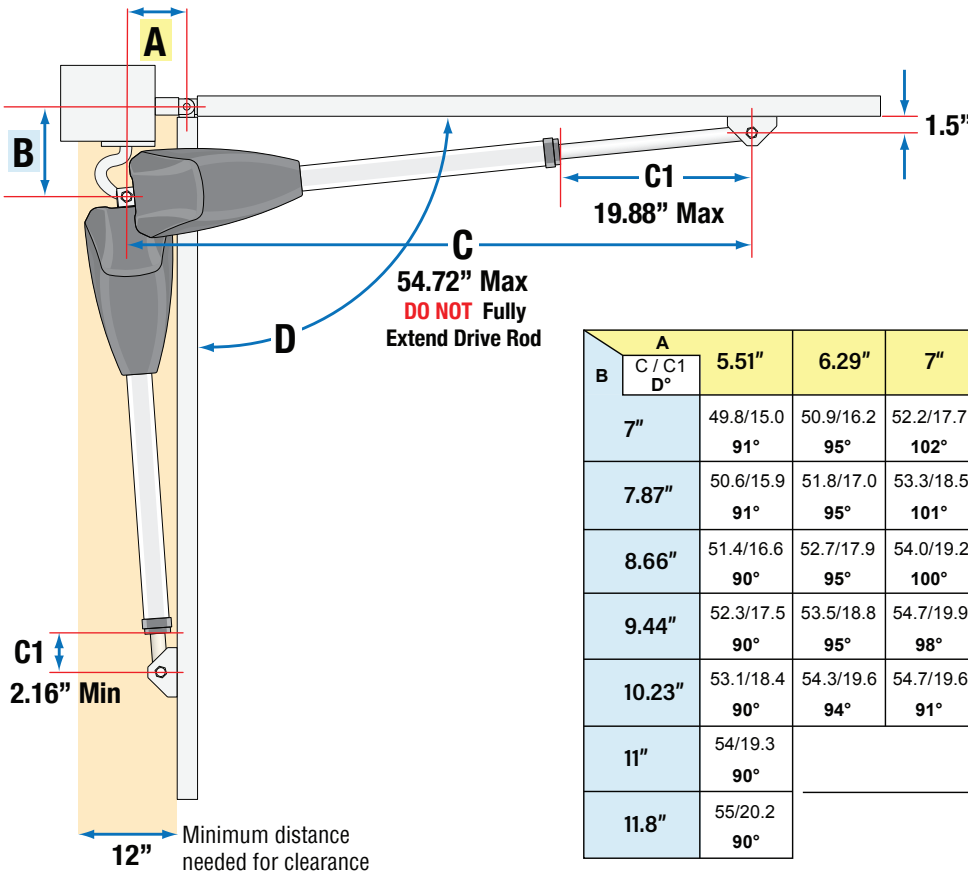

		Max Gate Weight/Length			
2300 lbs 1043 kg	8ft	12ft	16ft	20ft	
	2.4 m	3.6 m	4.8 m	6.0 m	

B	A						Max. gate width per gate
	C / C1 D°	5.51"	6.29"	7"	7.87"	8.66"	
7"	49.8/15.0 91°	50.9/16.2 95°	52.2/17.7 102°	54.0/19.3 108°	54.5/19.7 103°	54.2/19.4 96°	157.4"
7.87"	50.6/15.9 91°	51.8/17.0 95°	53.3/18.5 101°	54.4/19.6 103°	54.1/19.4 95°	54.5/19.7 93°	
8.66"	51.4/16.6 90°	52.7/17.9 95°	54.0/19.2 100°	54.5/19.7 97°	54.5/19.7 92°		
9.44"	52.3/17.5 90°	53.5/18.8 95°	54.7/19.9 98°	54.5/19.8 91°			177.2"
10.23"	53.1/18.4 90°	54.3/19.6 94°	54.7/19.6 91°				
11"	54/19.3 90°						
11.8"	55/20.2 90°						

Table in inches

**See next page for standard installation for common post sizes using the curved bracket.**

Standard installations based on common post sizes using the curved bracket with base plate

POST SIZE	3" x 3"	4" x 4"	5" x 5"
<b>A</b> DIMENSION	5.51"	5.51"	5.51"
<b>B</b> DIMENSION	8.9"	9.4"	9.9"

**3" x 3" POST**

(Open Position)

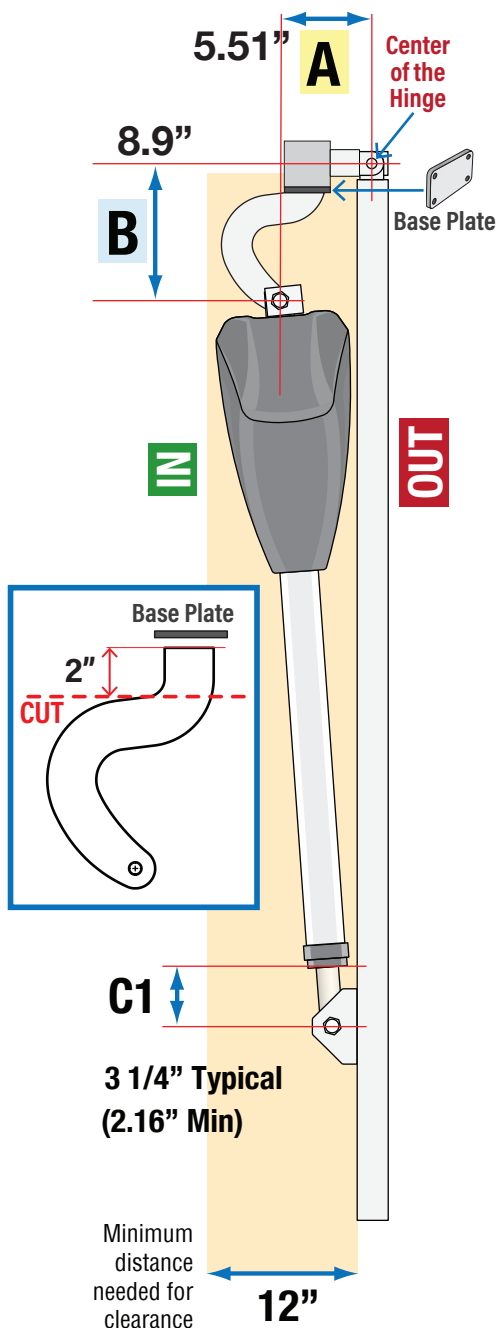

**4" x 4" POST**

(Open Position)

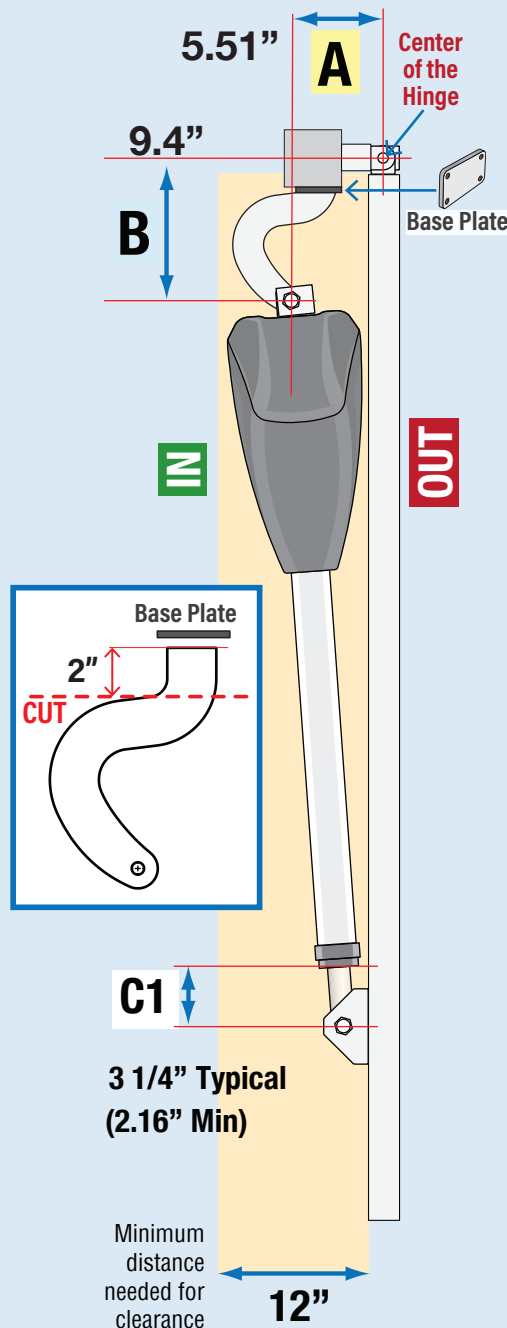

**5" x 5" POST**

(Open Position)

