

# MAX SUPER ARM 1300

## PULL OPEN CURVED BRACKET

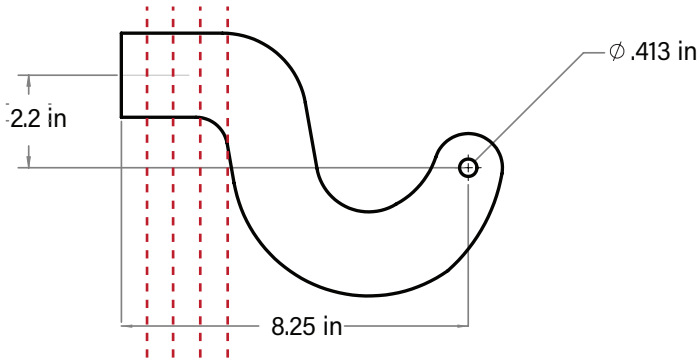

Mounting Hardware

Base Plate

Bolt or weld to secure.

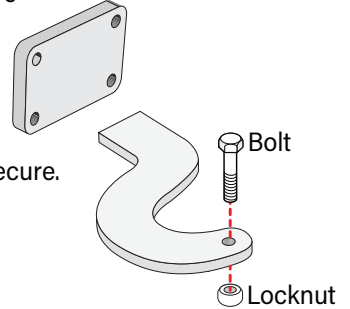

**Cut the base of the bracket to accomplish the proper B dimension.**

### 1300 PULL OPEN DIMENSIONS

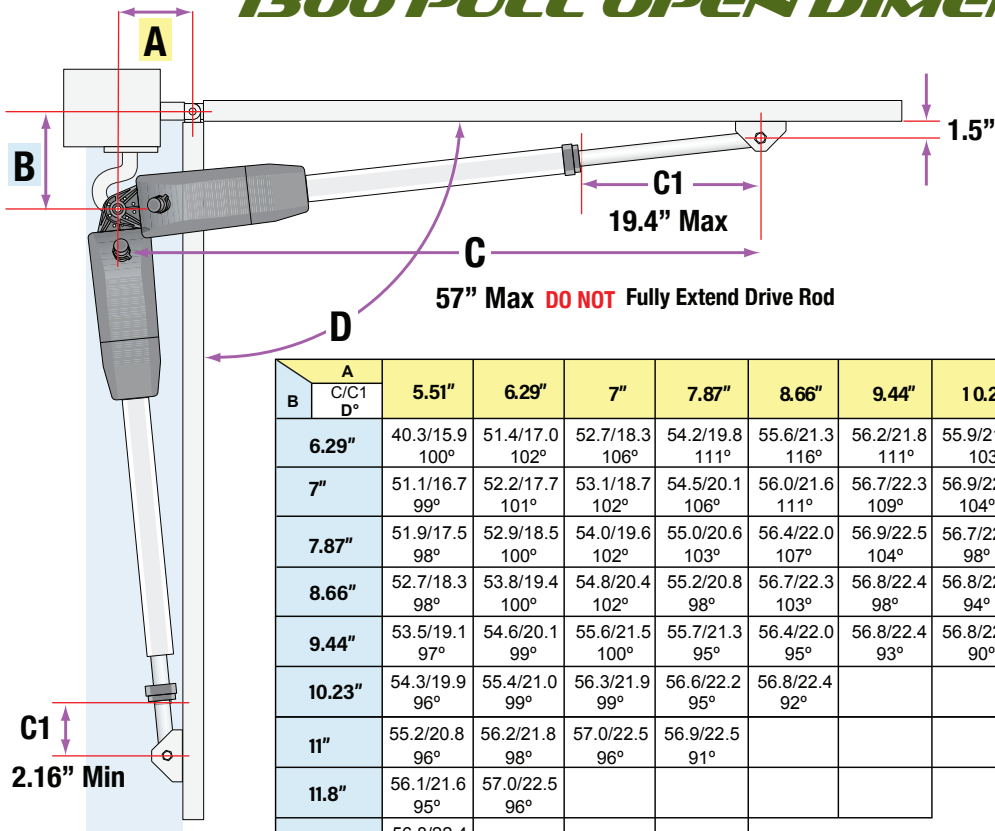

Max Gate Weight/Length	8ft	10ft	12ft
1300 lbs 589.6 kg	2.4 m	3.0 m	3.6 m
800 lbs 362.8 kg			
600 lbs 272 kg			

B	A									
	C/C1 D°	5.51"	6.29"	7"	7.87"	8.66"	9.44"	10.2"	11"	11.8"
6.29"	40.3/15.9 100°	51.4/17.0 102°	52.7/18.3 106°	54.2/19.8 111°	55.6/21.3 116°	56.2/21.8 111°	55.9/21.4 103°	56.5/22.1 102°	56.6/22.2 99°	56.6/22.2 96°
7"	51.1/16.7 99°	52.2/17.7 101°	53.1/18.7 102°	54.5/20.1 106°	56.0/21.6 111°	56.7/22.3 109°	56.9/22.5 104°	56.8/22.4 99°	56.6/22.2 95°	56.5/22.1 92°
7.87"	51.9/17.5 98°	52.9/18.5 100°	54.0/19.6 102°	55.0/20.6 103°	56.4/22.0 107°	56.9/22.5 104°	56.7/22.3 98°	56.8/22.4 95°	56.8/22.4 92°	56.9/22.5 90°
8.66"	52.7/18.3 98°	53.8/19.4 100°	54.8/20.4 102°	55.2/20.8 98°	56.7/22.3 103°	56.8/22.4 98°	56.8/22.4 94°	56.8/22.4 91°		
9.44"	53.5/19.1 97°	54.6/20.1 99°	55.6/21.5 100°	55.7/21.3 95°	56.4/22.0 95°	56.8/22.4 93°	56.8/22.4 90°			
10.23"	54.3/19.9 96°	55.4/21.0 99°	56.3/21.9 99°	56.6/22.2 95°	56.8/22.4 92°					
11"	55.2/20.8 96°	56.2/21.8 98°	57.0/22.5 96°	56.9/22.5 91°						
11.8"	56.1/21.6 95°	57.0/22.5 96°								
12.6"	56.8/22.4 93°									

Table in inches

Max. gate leaf width without electric lock  
137.8"

See next page for standard installation for common post sizes using the curved bracket.

Standard installations based on common post sizes using the curved bracket with base plate

POST SIZE	3" x 3"	4" x 4"	5" x 5"
<b>A</b> DIMENSION	5.51"	5.51"	5.51"
<b>B</b> DIMENSION	7.5"	8"	8.5"

**3" x 3" POST**

(Open Position)

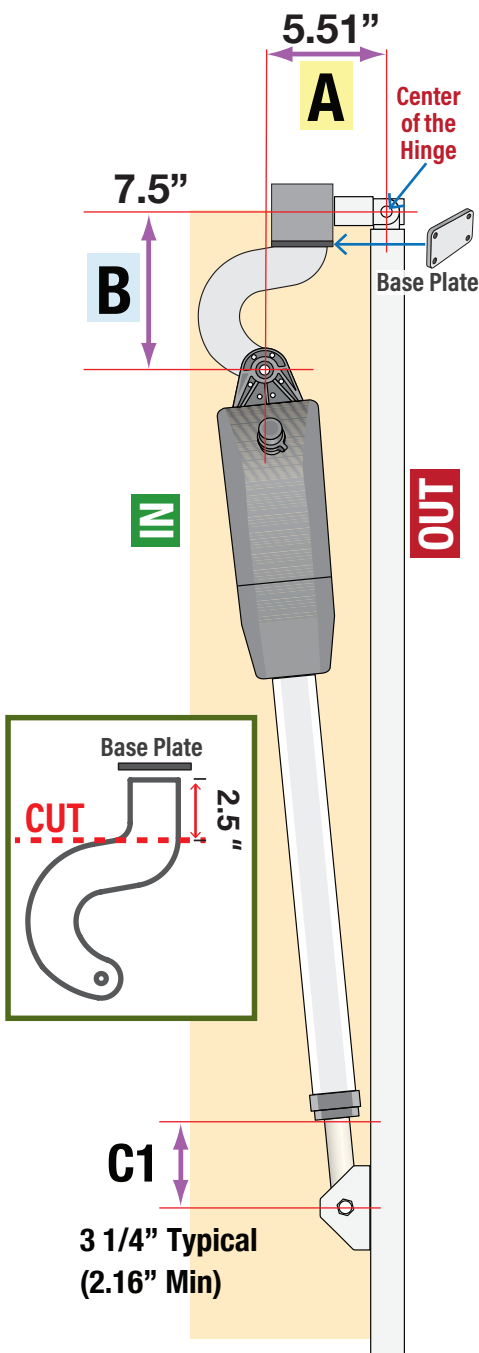

**4" x 4" POST**

(Open Position)

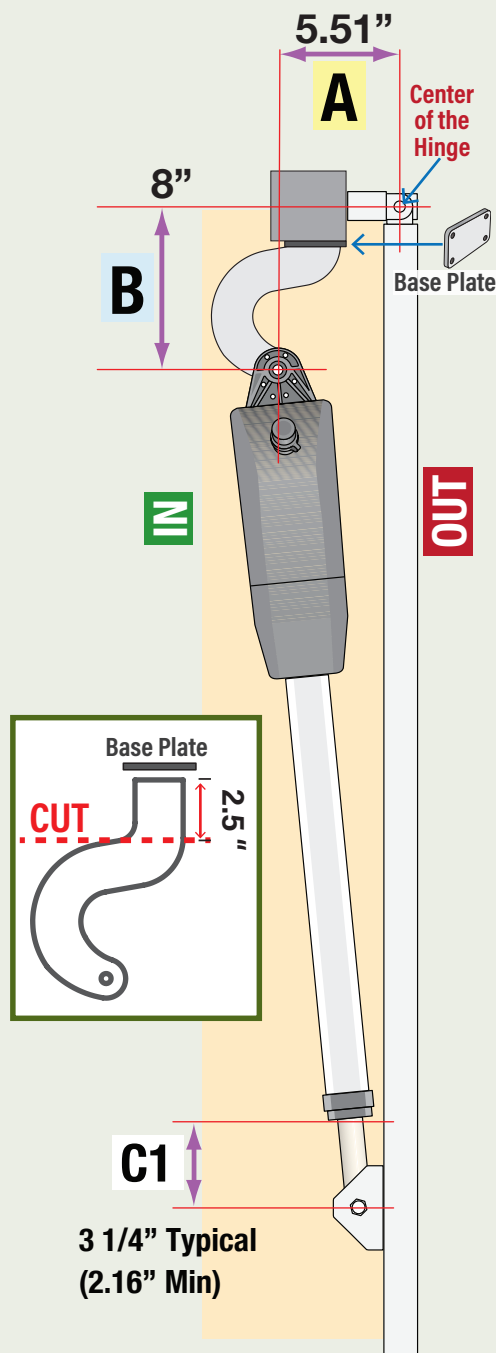

**5" x 5" POST**

(Open Position)

