

ULTRA ARM

PULL OPEN CURVED BRACKET

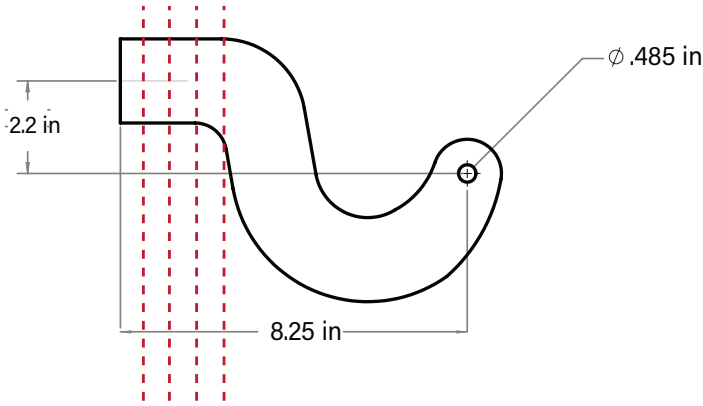

Mounting Hardware

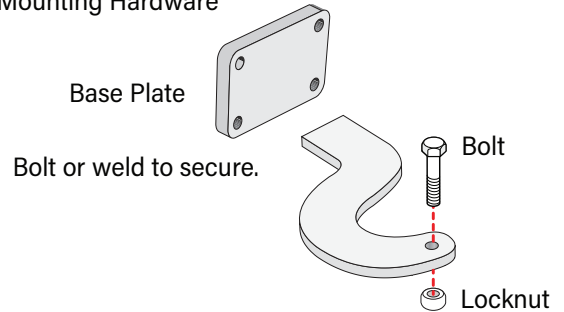

Cut the base of the bracket to accomplish the proper B dimension.

ULTRA ARM PULL OPEN DIMENSIONS

Option 1 allows fastest opening/ closing time (A dimensions being min allowed.)

	A	B	C
Option 1	5"	7"	59.25"
Option 2	6"	8"	59.25"
Option 3	7.5"	7.5"	59.25"

When "A" and "B" are similar dimensions, smoother gate operation and reduce motor strain occurs.

Maximum Open is 135° with Option 1

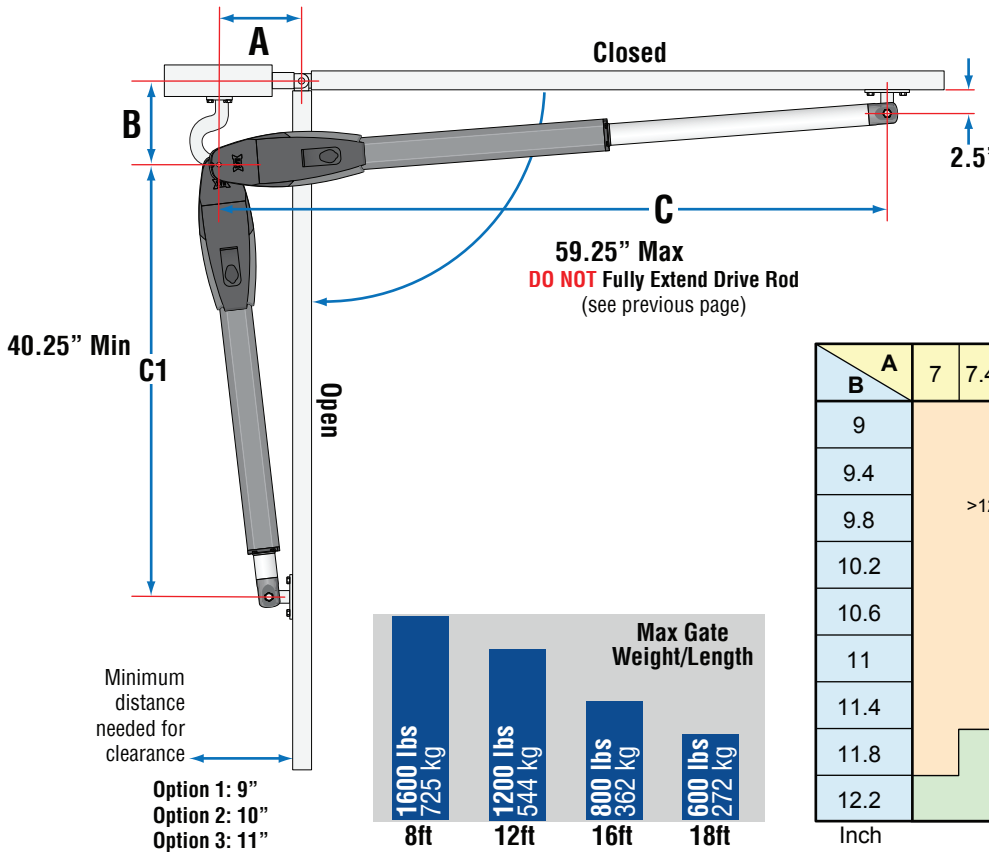

Minimum distance needed for clearance
 Option 1: 9"
 Option 2: 10"
 Option 3: 11"

Gate Weight	Gate Length
1600 lbs / 725 kg	8ft
1200 lbs / 544 kg	12ft
800 lbs / 362 kg	16ft
600 lbs / 272 kg	18ft

Max Gate Weight/Length

B \ A	7	7.4	7.8	8.2	8.6	9	9.4	9.8	10.2	Inch
9	>120°						110-120°			
9.4							100-110°			
9.8	90-110°									
10.2										
10.6										
11										
11.4										
11.8										
12.2							<90°			
Inch										

See next page for standard installation for common post sizes using the curved bracket.

Standard installations based on common post sizes using the curved bracket with base plate

POST SIZE	3" x 3"	4" x 4"	5" x 5"
A DIMENSION	5"	5"	5"
B DIMENSION	7.6"	8.1"	8.6"

3" x 3" POST

(Open Position)

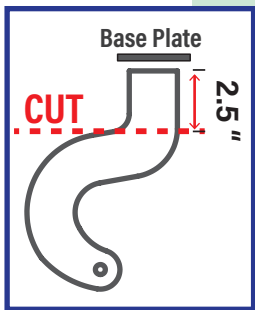
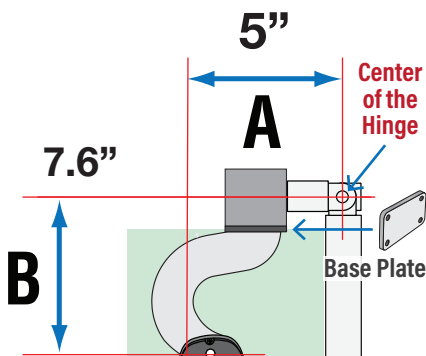

X1 \updownarrow
5.5" Typical

4" x 4" POST

(Open Position)

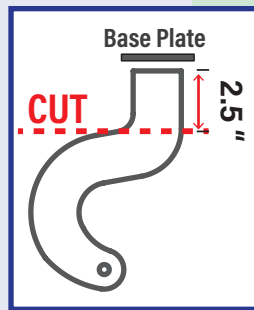
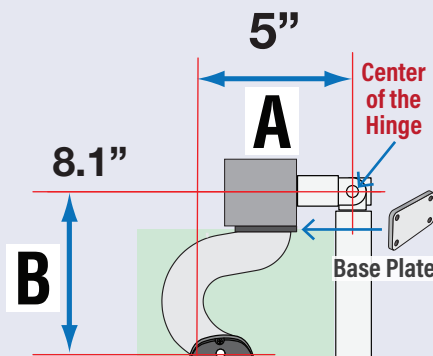

X1 \updownarrow
5.5" Typical

5" x 5" POST

(Open Position)

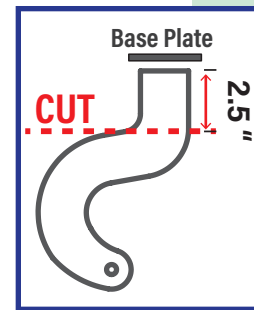
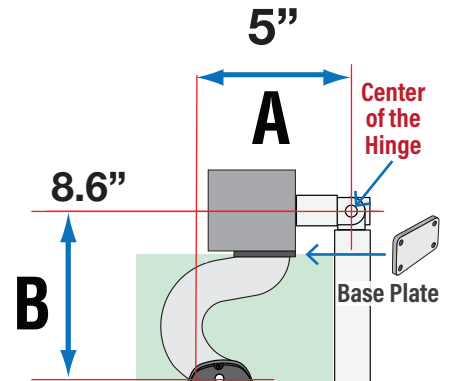

X1 \updownarrow
5.5" Typical