

MAX Wireless Relay



The MAX wireless relay is designed to wirelessly transmit and receive a signal from the gate operator to control desired functions remotely.

The 2 individual relays function independently from each other allowing 2 different applications to be used and they can vary greatly. Almost any device with a dry contact input (switch ON or OFF) can be used. A few examples are:

- Opening Device
- Gate Tamper monitoring and controlling
- Monitor the gate Open and Closed positions
- Turn on safety devices when the gate opens
- Operate with an existing alarm system

The 900 MHz signal is long range (up to a mile away) and robust, making the signal almost immune to any interference.

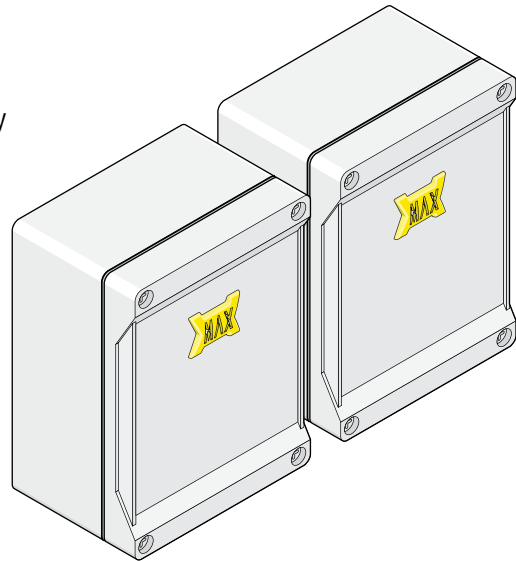

RELAY DESCRIPTION

((((((((900MHz Robust Signal))))))))

Up to 1 Mile apart using Line-of-Sight

INPUT 2 activates RELAY 2

RANGE TEST:
Channels **MUST** match on both units.
Must remain **OFF** during normal operation.

CHANNEL:
ONLY use channels 0 thru 6.
Channels **MUST** match on both units.

Signal QUALITY:
4 - Excellent
3-4 - Good
2-3 - Poor

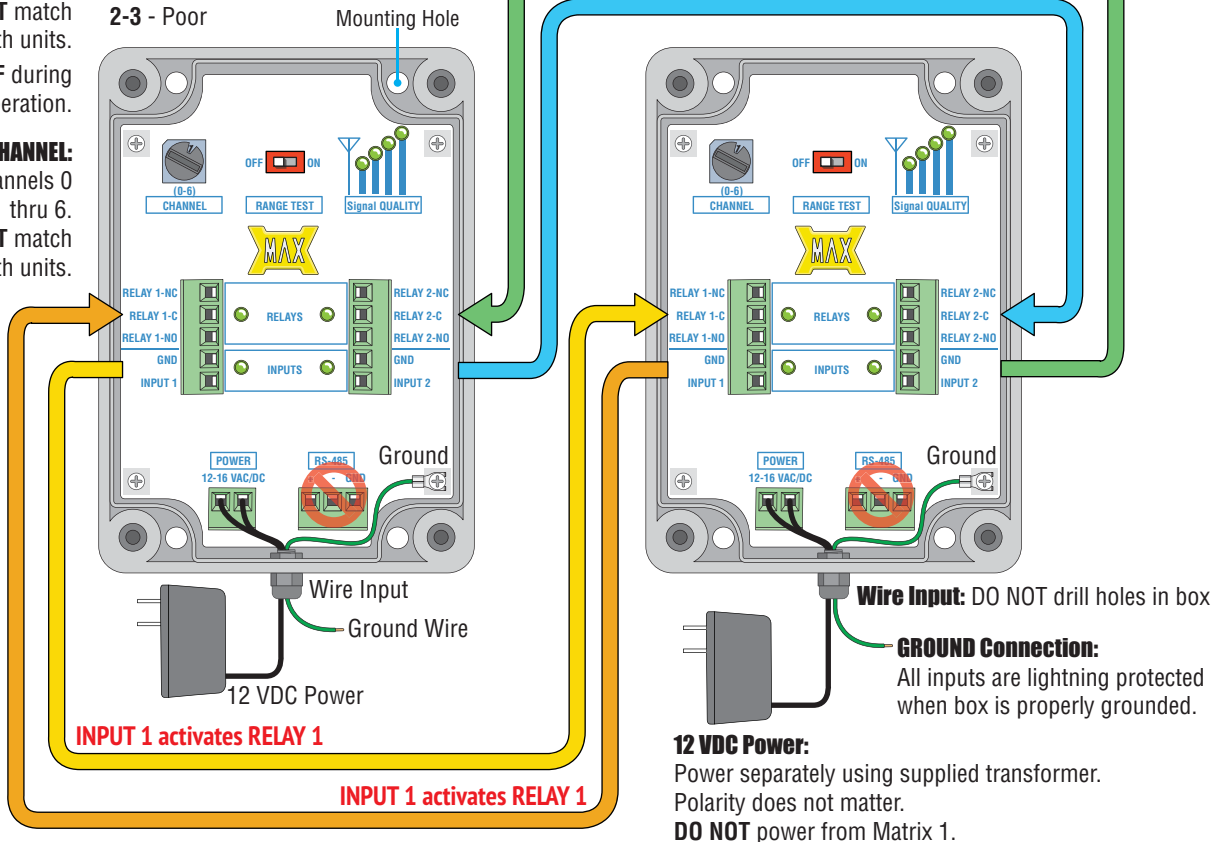

MAX Wireless Relay



WIRELESS OPENING OPTIONS

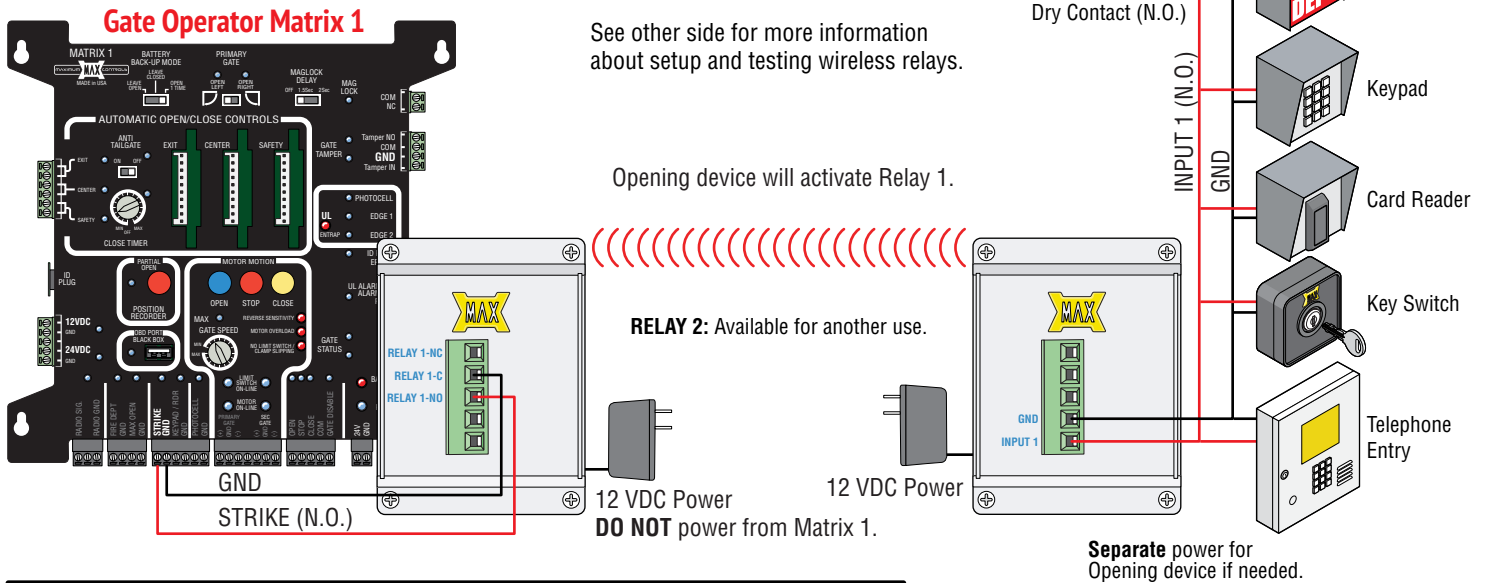

WIRELESS GATE TAMPER

The **GATE TAMPER** can be used for various functions such as turning a warning light, siren or camera on when the gate is tampered with (Vandalized Gate). The gate operator defines a "Vandalized Gate" as **UNAUTHORIZED** movement of the gate. This can occur if the chain is dropped and gate is manually moved from the **closed position** or the gate is forced open from the **closed position without authorization**.

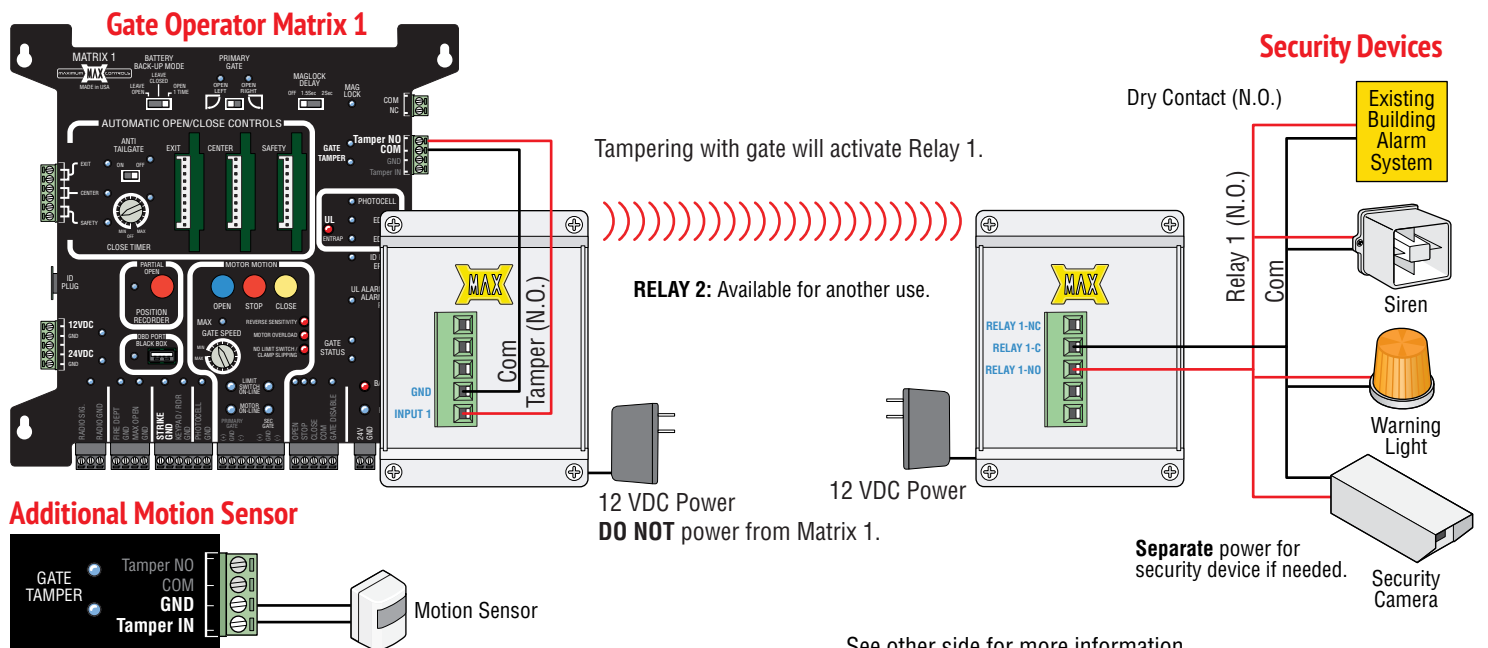

If a motion sensor is added to the Tamper IN input, when the motion sensor gets triggered, security device that is wired to Tamper NO - RELAY 1 will activate (see above).

See other side for more information about setup and testing wireless relays.